

# CONVENTION CENTER - MAP

The Alerus Center's convention facilities consists of the main ballroom and 12 conference rooms.

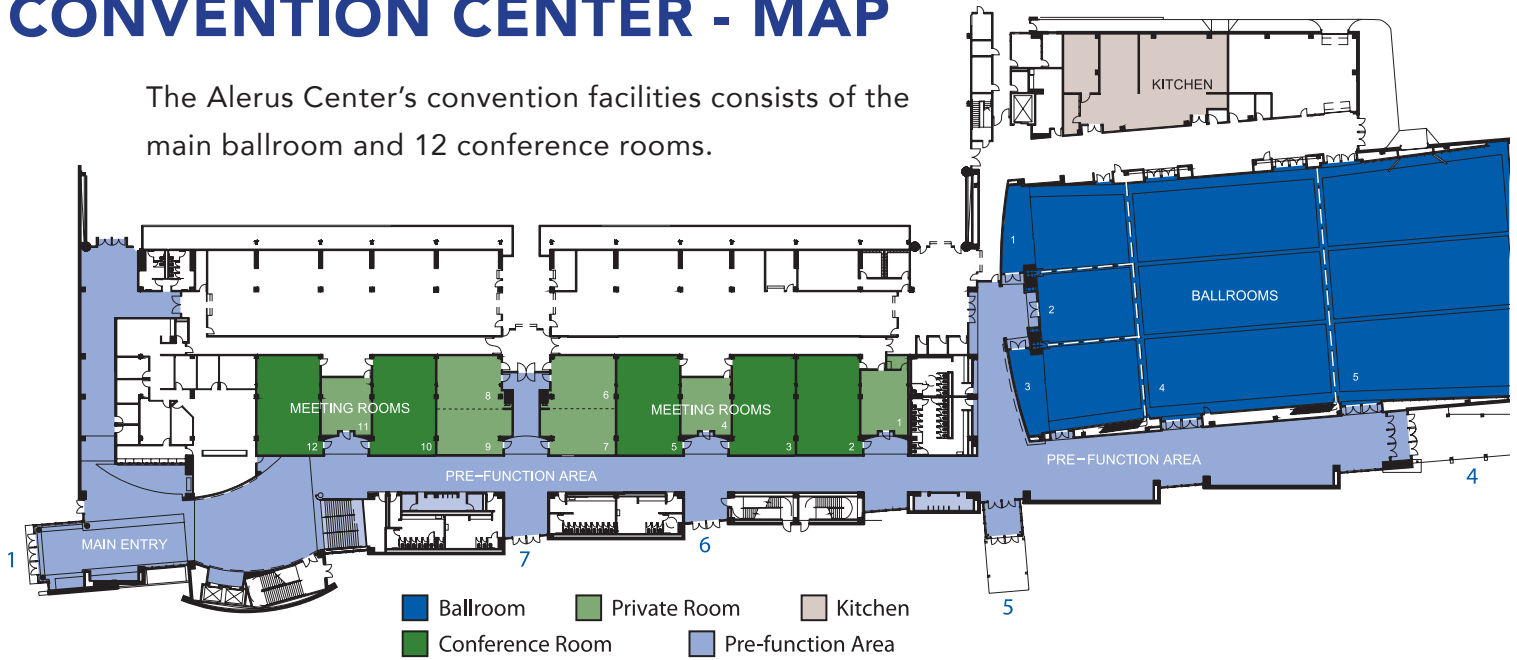

## BALLROOM STATISTICS

All Ballrooms	Ballroom 5	Ballroom 4	Junior Ballroom 1&3	Junior Ballroom 2
<b>25,588 sq. ft.</b>	<b>10,350 sq. ft.</b>	<b>9,790 sq. ft.</b>	<b>2,052 sq. ft.</b>	<b>1,344 sq. ft.</b>
Theater..... 3,150 ppl	Theater..... 1,000 ppl	Theater..... 1,000 ppl	Theater..... 188 ppl	Theater..... 80 ppl
Banquet ..... 1,000 ppl	Banquet ..... 400 ppl	Banquet ..... 400 ppl	Banquet ..... 100 ppl	Banquet ..... 40 ppl
Classroom ..... 1,400 ppl	Classroom ..... 352 ppl	Classroom ..... 352 ppl	Classroom ..... 92 ppl	Classroom ..... 40 ppl
Trade Show ..140 booths	Trade Show ... 55 booths	Trade Show ... 55 booths	Hollow Square..... 56 ppl	Hollow Square..... 24 ppl

## MEETING ROOMS STATISTICS

<ul style="list-style-type: none"> <li>· Oriole · Pheasant · Hawk · Eagle</li> <li>· Meadowlark · Bluebird/Finch</li> <li>· Cardinal/Hummingbird</li> </ul>	<ul style="list-style-type: none"> <li>· Bluebird · Finch · Cardinal</li> <li>· Hummingbird</li> </ul>	<ul style="list-style-type: none"> <li>· Robin · Canary</li> </ul>
<b>Approximately 1,380 sq. ft.</b>	<b>Approximately 690 sq. ft.</b>	<b>Approximately 598 sq. ft.</b>
Theater..... 108 ppl	Theater..... 32 ppl	Theater..... 50 ppl
Banquet ..... 60 ppl	Banquet ..... 20 ppl	Banquet ..... 30 ppl
Classroom ..... 52 ppl	Classroom ..... 16 ppl	Classroom ..... 24 ppl
Hollow Square..... 32 ppl	Hollow Square..... 16 ppl	Hollow Square..... 16 ppl

*Mourning Dove is 598 sq ft, and is set up as a Board Room with seating for 24.*

## ROOMS ASSIGNMENTS

1 MOURNING DOVE	5 HAWK	9 HUMMINGBIRD
2 ORIOLE	6 BLUEBIRD	10 EAGLE
3 PHEASANT	7 FINCH	11 CANARY
4 ROBIN	8 CARDINAL	12 MEADOWLARK

**ALERUS**  
**CENTER**

1200 42nd Street South  
Grand Forks, North Dakota 58201  
701.792.1200 · www.aleruscenr.com

\* Information is subject to change, based on client needs.